

Instructions for Linking the Instant Meter to QEH Glooko account via the Glooko App



1. Download the Glooko App



2. Once you have created your account go the home screen and touch sync

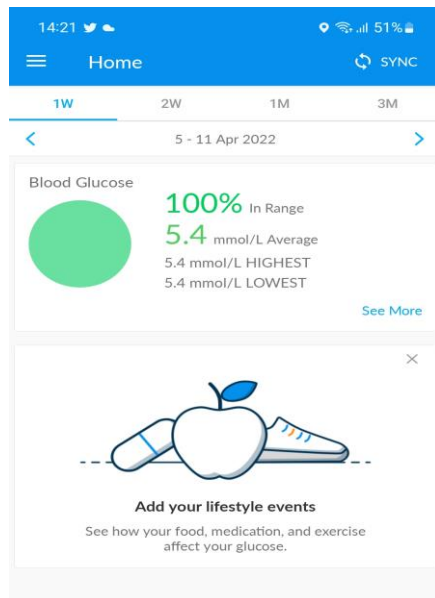

3. Then click on add new device

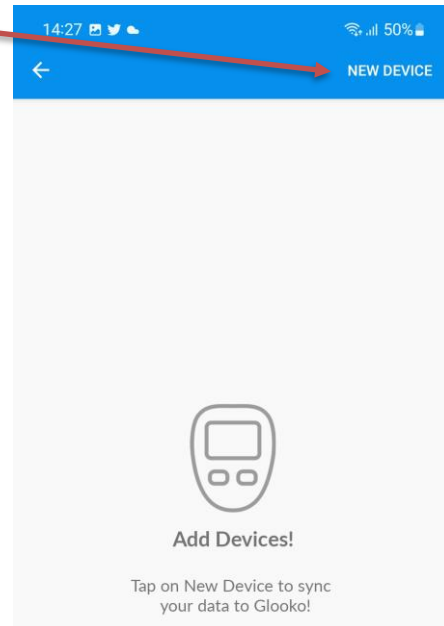

4. Then select Blood Glucose Meters and press continue

5. Select "Instant" then press Add (1)

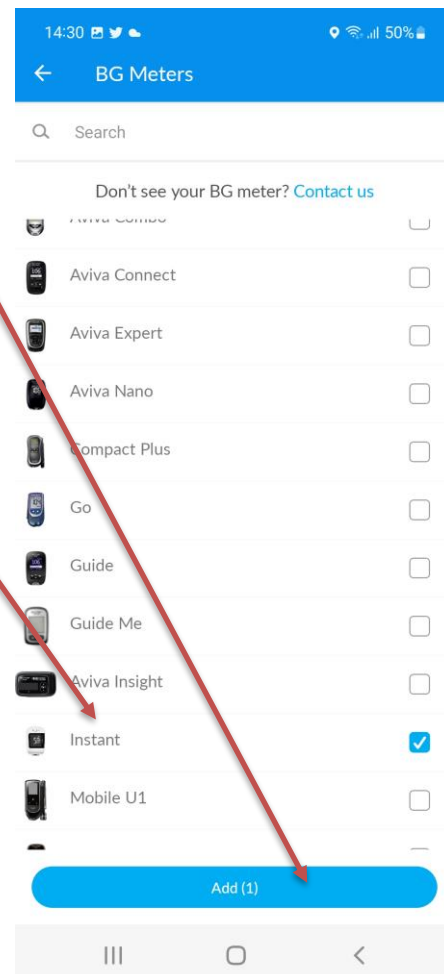

6. Follow the instructions on the screen, but please note that you have to press and hold the bottom right button on the instant meter to put it into Bluetooth sharing mode, not the top right, as shown on the diagram in the app.

7. Once the meter and app are paired go back to the home screen and select the menu button

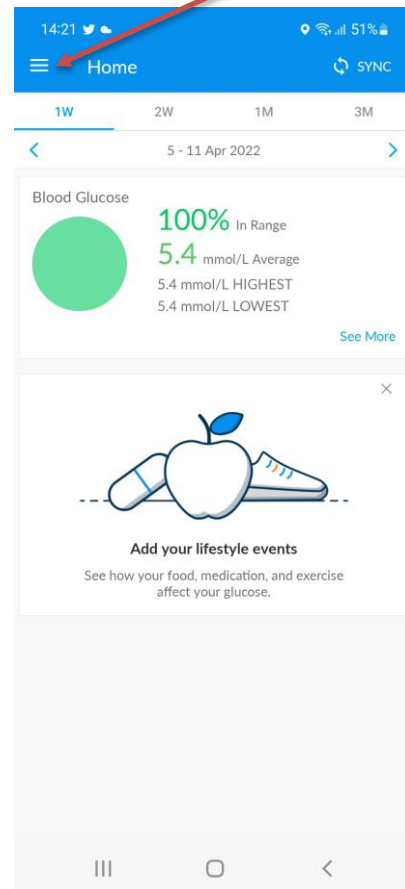

8. Then select "Profile"

9. Under the Personal Tab please select "ProConnect"

10. Then press "+ Add Code"

11. The enter "enqeadu"

12. This will allow you to pair your account with the QEH one. We can then review your glucose levels in real time.